

The City of Prince George does not represent or guarantee that the information contained in this document is accurate or reliable, and any person who relies on this information in this document does so at their own risk.

City of Prince George
This information has been provided subject to the Federal Copyright Act and in accordance with the Provincial Freedom of Information and Protection of Privacy Act

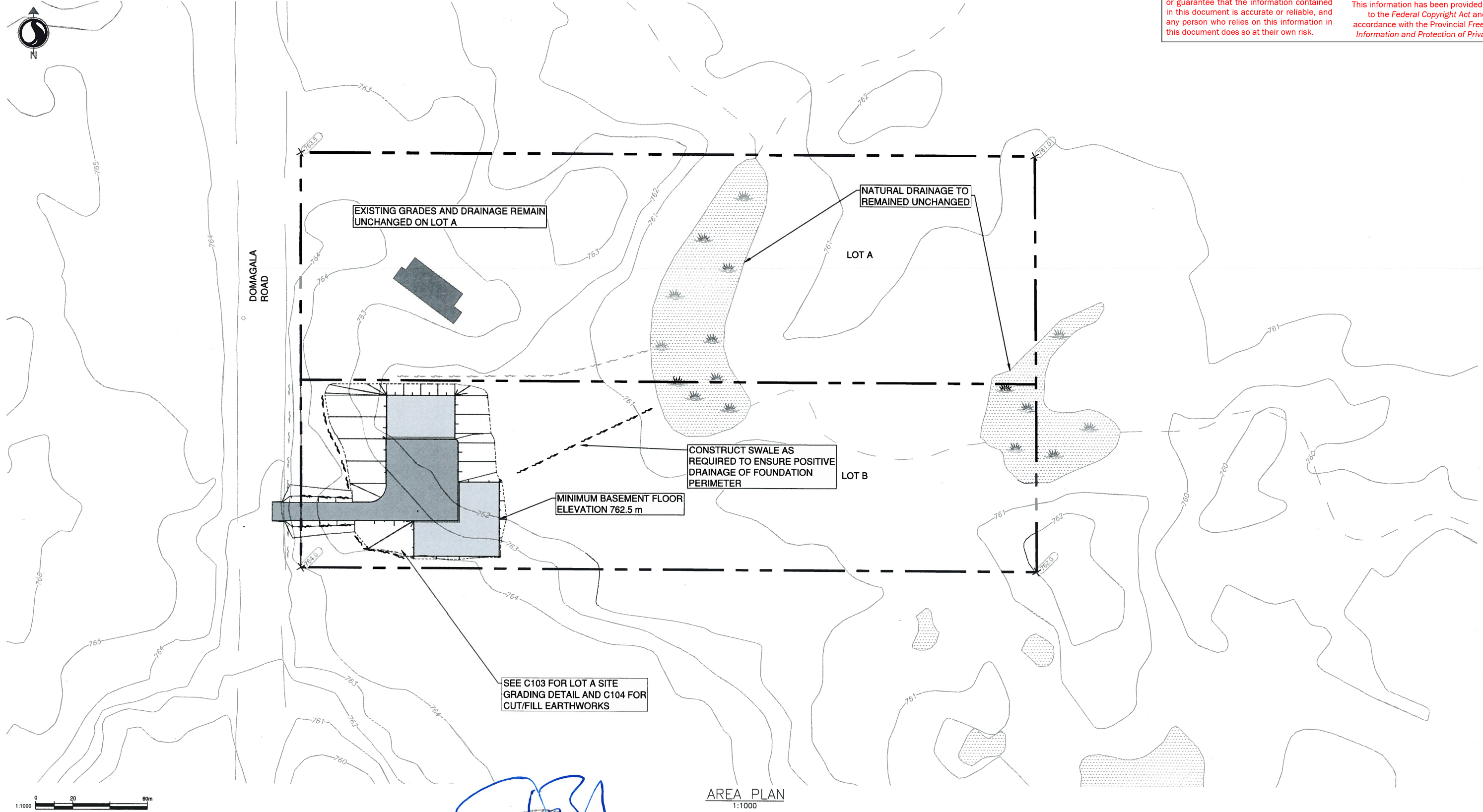

AREA PLAN
1:1000

Revision	By	Appd.	YY.MM.DD

Issued	By	Appd.	YY.MM.DD
REISSUED FOR APPROVAL	KB	SB	23.11.03
ISSUED FOR APPROVAL	KB	SB	23.10.04

Permit-Seq#

Nov 3/2023

STANTEC PERMIT #1002862

Consultants

205 - 1302 7TH AVENUE
PRINCE GEORGE, BC V2L 3P1
www.stantec.com

Copyright Reserved

The Contractor shall verify and be responsible for all dimensions. DO NOT scale the drawing - any errors or omissions shall be reported to Stantec without delay. The Copyrights to all designs and drawings are the property of Stantec. Reproduction or use for any purpose other than that authorized by Stantec is forbidden.

Client/Project
DoB CONSTRUCTION

SUBVISION OF LOT 8 DISTRICT LOT 2424
PLAN 21853
PRINCE GEORGE

File Name: 115823039.DWG

KB	CEM	SRB	23.11.03
Dwn.	Chkd.	Dsgn.	YY.MM.DD

Title
DRAINAGE

Project No. 115823039
Scale AS NOTED

Drawing No. C102
Sheet 2 of 7
Revision -



The City of Prince George does not represent or guarantee that the information contained in this document is accurate or reliable, and any person who relies on this information in this document does so at their own risk.

City of Prince George
This information has been provided subject to the Federal Copyright Act and in accordance with the Provincial Freedom of Information and Protection of Privacy Act

PROPOSED RAIN WATER LEADER (RWL)
DRAIN TOWARDS SWALE

EXISTING GRADES AND DRAINAGE
TO REMAIN UNCHANGED ON LOT A

EXISTING DITCH

GARAGE/SHOP FFE 764.0 (TOC)

PROPOSED RWL DISCHARGE TO SWALE

LOT B

PERIMETER DRAIN INV 761.5 DISCHARGE TO SWALE

BACKUP SUMP PUMP (DISCHARGE TO EXTERIOR
SPLASH PAD)

LEGEND	
	RAIN WATER LEADER DISCHARGE
	SUMP PUMP
	SWALE
	EXISTING SPOT ELEVATION
	PROPOSED SPOT ELEVATION

MAIN FLOOR
FFE 765.2 (TOC)

MINIMUM BASEMENT FLOOR ELEVATION 762.5

GARAGE FFE 764.5 (TOC)

REQUIRES 4 STAIRS
TO ACCESS MAIN FLOOR OF RESIDENCE

AREA PLAN
1:400

Revision	By	Appd.	YY.MM.DD

ISSUED FOR APPROVAL	KB	SB	23.11.03
ISSUED FOR APPROVAL	KB	SB	23.10.04
ISSUED	By	Appd.	YY.MM.DD

Permit-Seal

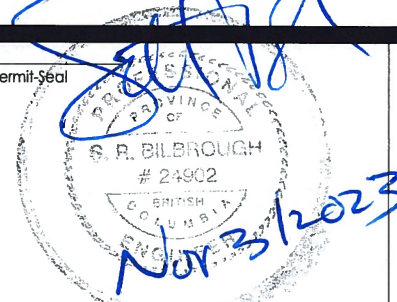

STANTEC PERMIT #1002862

Consultants



205 - 1302 7TH AVENUE
PRINCE GEORGE, BC V2L 3P1
www.stantec.com

Copyright Reserved

The Contractor shall verify and be responsible for all dimensions. DO NOT scale the drawing - any errors or omissions shall be reported to Stantec without delay.
The Copyrights to all designs and drawings are the property of Stantec. Reproduction or use for any purpose other than that authorized by Stantec is forbidden.

Client/Project

DoB CONSTRUCTION

SUBDIVISION OF LOT 8 DISTRICT LOT 2424
PLAN 21853
PRINCE GEORGE

File Name: 115823039.DWG

KB	CEM	SRB	23.11.03
Dwn.	Chkd.	Dsgn.	YY.MM.DD

Title

SITE GRADING - LOT A DETAIL

Project No.
115823039

Scale
AS NOTED

Drawing No.
C103

Sheet
3 of 7

Revision

-