

LEGAL DESCRIPTION  
LOT 13 DL 2424 PLAN 9563  
PID: 012-900-206

EXISTING ZONING  
AR3m

DEVELOPMENT AREA  
6471.8m<sup>2</sup> (0.6 ha.)

- NOTES:
1. TOPOGRAPHIC SURVEY PERFORMED NOVEMBER 20, 2018 BY L&M ENGINEERING LTD.
  2. CONTOURS SHOWN WERE CREATED FROM 2014 CITY OF PRINCE GEORGE LIDAR INFORMATION.
  3. PROPERTY LINES SHOWN ARE APPROXIMATE.
  4. UNDERGROUND SERVICES AND LOCATIONS ARE APPROXIMATE AND MUST BE VERIFIED BEFORE EXCAVATION.

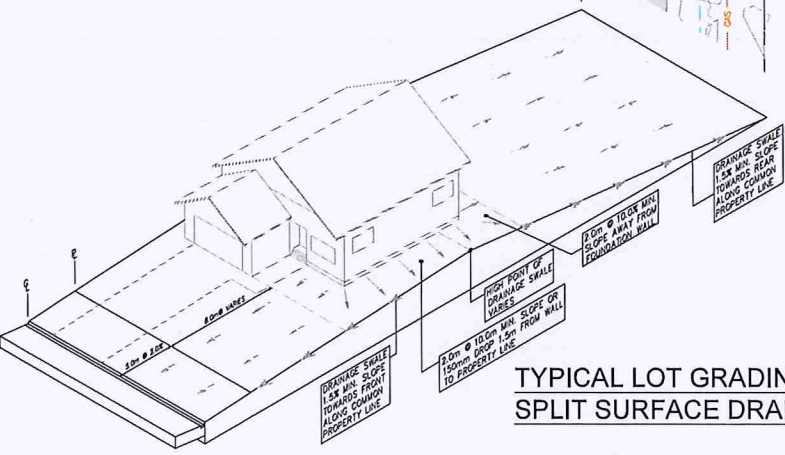
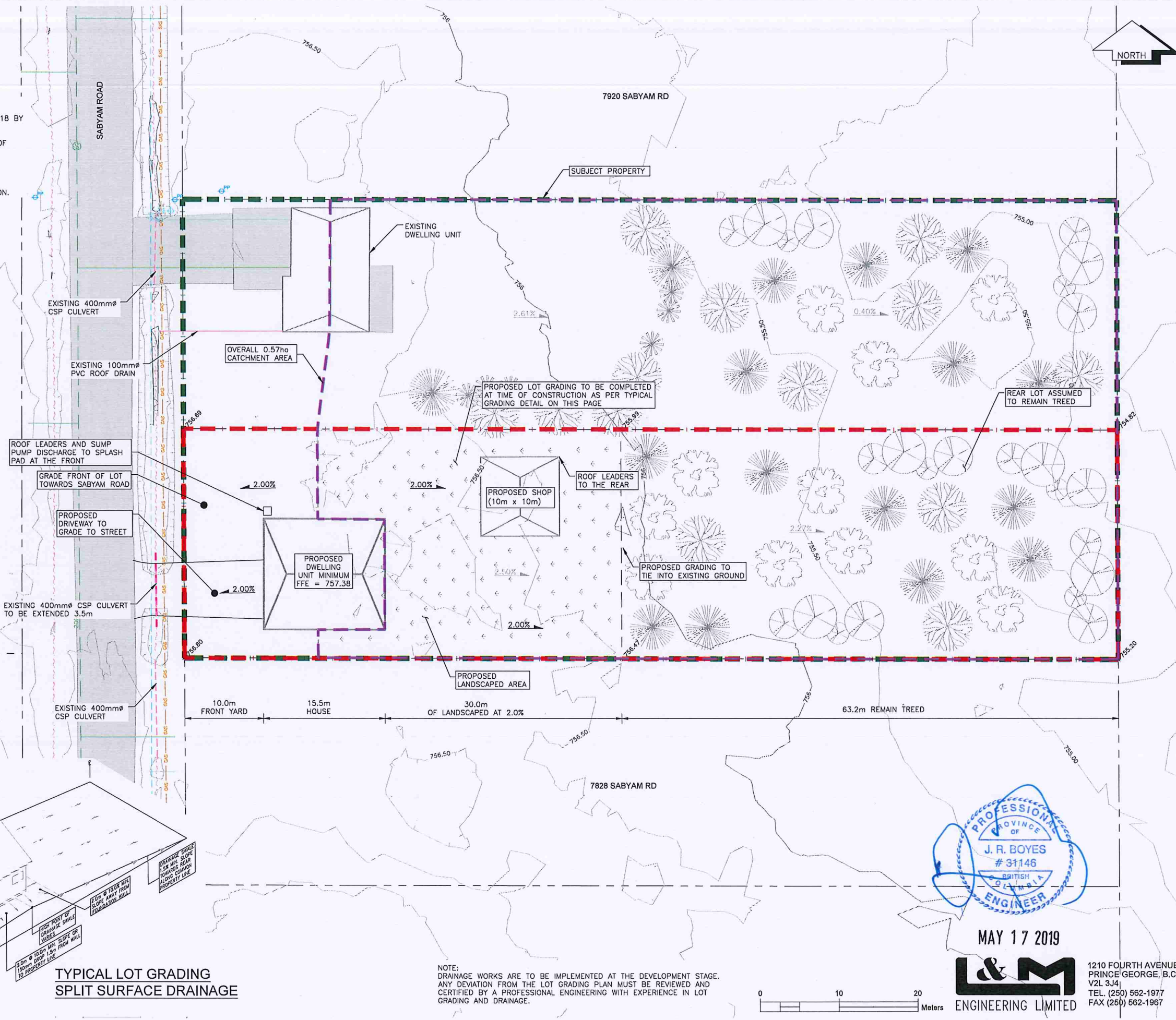

**LEGEND**

645.92	EXISTING GROUND ELEVATION
1.00%	EXISTING GRADE
1.00%	PROPOSED GRADE
<b>EXISTING</b>	
---	EX. LEGAL LINE
---	EX. LEGAL R.O.W. & EASEMENT
---	EX. SANITARY & MANHOLE
---	EX. SANITARY FORCE MAIN
---	EX. STORM & MANHOLE
---	EX. SINGLE & DOUBLE CATCHBASIN w/ CB LEADS
---	EX. CATCHBASIN MANHOLE
---	EX. CULVERT
---	EX. FIRE HYDRANT & VALVE ASSEMBLY
---	EX. WATERMAIN & VALVE
---	EX. BLOW-OFF ASSEMBLY
---	EX. CURB STOP
---	EX. ROAD & SIDEWALK
---	EX. ROAD SIGN(S)
---	EX. SHOULDER
---	EX. TOP OF SLOPE
---	EX. TOE OF SLOPE
---	EX. DITCH or SWALE
---	EX. FENCE
---	EX. OVERHEAD LINES
---	EX. UNDERGROUND LINES
---	EX. POWER POLE & ANCHOR
---	EX. GAS MAIN
<b>PROPOSED</b>	
---	PR. LEGAL LINE
---	PR. LEGAL R.O.W. & EASEMENT
---	PR. SANITARY & MANHOLE
---	PR. STORM & MANHOLE
---	PR. SINGLE & DOUBLE CATCHBASIN w/ CB LEADS
---	PR. CATCHBASIN MANHOLE
---	PR. CULVERT
---	PR. DITCH or SWALE
---	PR. FIRE HYDRANT & VALVE ASSEMBLY
---	PR. WATERMAIN & VALVE
---	PR. GRAVEL SHOULDER
---	PR. ASPHALT
---	PR. CURB & SIDEWALK
---	PR. ROAD SIGN(S)

NO.	DATE	REVISION	DR.



DRAWN:	MM
CHECKED:	DDS
ENGINEER:	JRB
SURVEY FILE:	
DRAWING FILE:	CJD18 1660-01 BASE.dwg
CORRESPONDENCE:	CPG
GRID:	
DATE:	DECEMBER 2018
SCALES:	FULL 1:250 HALF 1:500

DUAINE YEZOVICH  
7912 Sabyam Road  
1 LOT RESIDENTIAL SUBDIVISION  
OVERALL SITE PLAN  
& LOT GRADING

CONSULTANTS PROJECT No.  
**1660-01**  
DRAWING No.  
**C001**

SHEET No.	REV. No.
1 OF 1	0

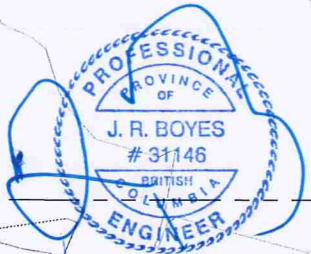

MAY 17 2019

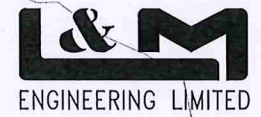

1210 FOURTH AVENUE  
PRINCE GEORGE, B.C.  
V2L 3J4  
TEL. (250) 562-1977  
FAX (250) 562-1967

NOTE:  
DRAINAGE WORKS ARE TO BE IMPLEMENTED AT THE DEVELOPMENT STAGE.  
ANY DEVIATION FROM THE LOT GRADING PLAN MUST BE REVIEWED AND  
CERTIFIED BY A PROFESSIONAL ENGINEERING WITH EXPERIENCE IN LOT  
GRADING AND DRAINAGE.

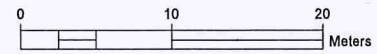

C:\Jobs\Plan\1660\1660 - Duaine Yezovich\01 - 7912 Sabyam Rd\2-Section\CJD18 1660-01 BASE.dwg