

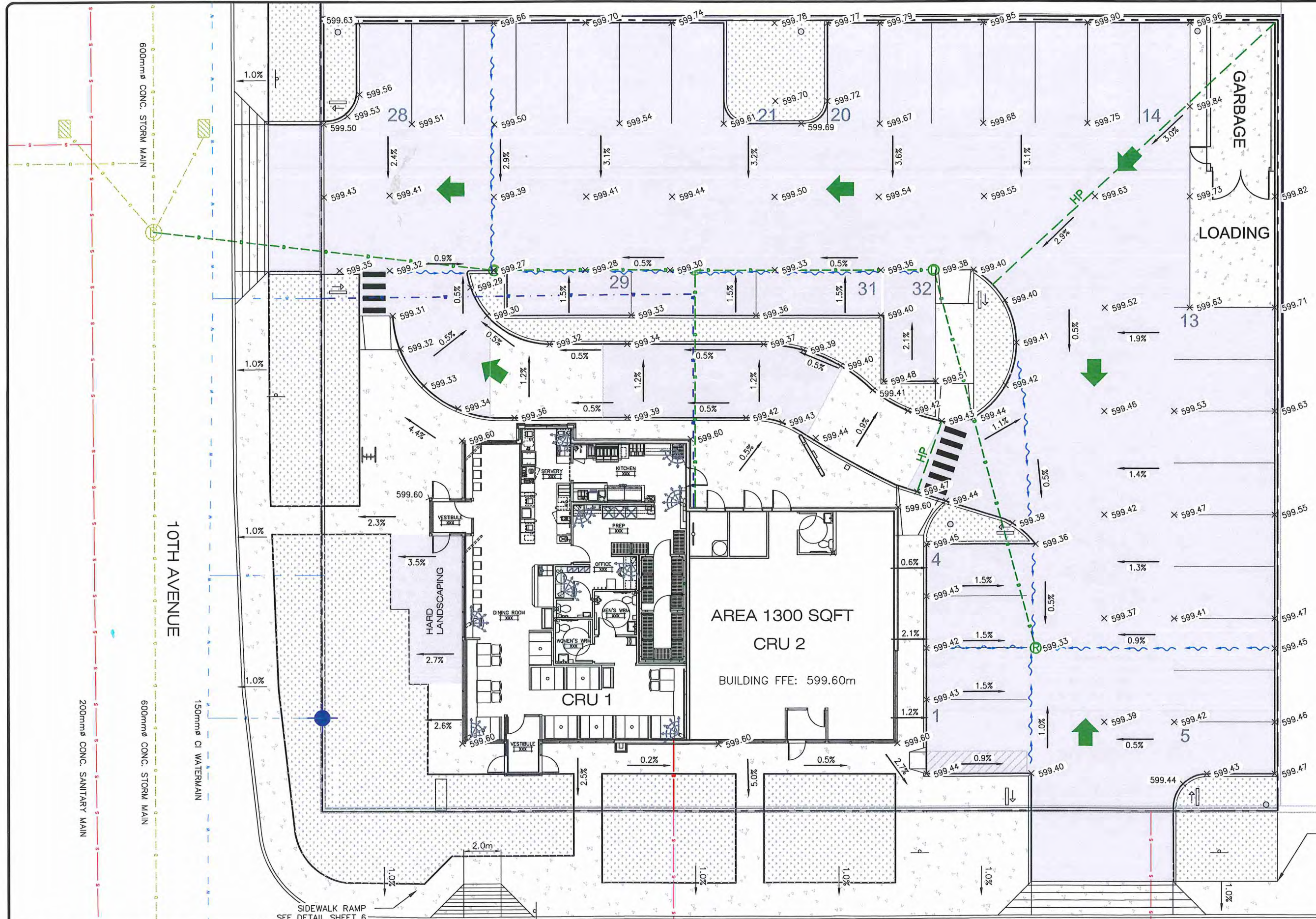

- 1) ALL WORKS SHALL MEET OR EXCEED THE REQUIREMENTS OUTLINED IN SCHEDULE C, INFRASTRUCTURE SPECIFICATIONS AND SCHEDULE D, STANDARD INFRASTRUCTURE DRAWINGS OF THE CITY OF PRINCE GEORGE SUBDIVISION AND DEVELOPMENT SERVICING BYLAW 7652, 2004.
- 2) AN ASBUILT TOPOGRAPHIC SURVEY OF THE SITE WAS NOT COMPLETED. RADLOFF HAS REVIEWED THE SITE FOR GENERAL CONFORMANCE OF THE GRADING, BUT SPECIFIC ELEVATIONS HAVE NOT BEEN VERIFIED.



R. RADLOFF  
 #12003  
 08/19/2015

\*PROPOSED CURB ELEVATIONS SHOWN ARE AT THE GUTTER LINE

EXTENT OF CONCRETE SIDEWALK. REMOVE 1m OF ASPHALT SIDEWALK PAST PROPERTY LINE AND INSTALL ASPHALT CROSSFALL TRANSITION (TYP)

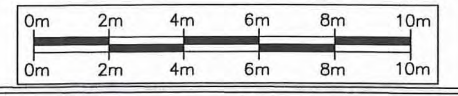

**Radloff**  
 R. Radloff & Associates Inc.  
 Engineering, Planning & Consulting  
 1820 3rd Avenue  
 Prince George, B.C. V2M 1G4  
 Ph: (250) 562-6861, Fax: (250) 562-6826

DATE	ISSUED FOR	BY	APPROVED
15/08/19	AS-BUILT	RPR	
15/03/20	ISSUED FOR CONSTRUCTION	RPR	
15/01/07	ISSUED FOR TENDER R2	RPR	
14/11/25	ISSUED FOR TENDER R1	RPR	
14/10/17	ISSUED FOR TENDER	RPR	
14/09/22	ISSUED FOR BUILDING PERMIT	RPR	
	DRAWING ISSUE		

NO.	DATE	REVISION	BY	APPROVED
2	15/03/25	REVISED SITE PLAN BASED ON CPG COMMENTS	DJF	CEM
1	14/09/28	REVISED SITE PLAN BASED ON CPG COMMENTS	AOK	CEM

WHITE SPOT LIMITED  
 PRINCE GEORGE TRIPLE O'S

SITE GRADING  
 PLAN  
 SCALE: HOR: 1:100 VERT:

DESIGNED BY: AOK	FILE#: 860-002-04
DRAWN BY: AOK	DWG.# 860-002-04
CHECKED BY: SAR/CEM	SHEET C-3
DATE: 15/08/19	REVISION R2